



NMR-LCF12-E01

N Male Connector for 1/2" Coaxial Cable, OMNI FIT™ Premium,  
Right Angle, polymer claw and compression sealing



OMNI FIT™ high performance connectors are designed for use with both CELLFLEX® (copper) and CELLFLEX® Lite (aluminium) cables. They are designed specifically to provide the highest quality connector-cable interface while simplifying and speeding up connector attachment. All RFS connectors are fully tested for mechanical and electrical compliance to industry specifications.  
The 7-16 connector is the most rugged RF connection meeting all requirements even under the most severe environmental conditions. Sealing against outer conductor and jacket by means of the polymer claw and 360° compression fit. Multifunctional, self-lubricating HighTech polymer assembly locks on cable corrugation, avoids electrochemical potential differences and compression-fits to the jacket.

Feature / Benefits

- Ultra high PIM performance i.e. reduced interference leading to high customer satisfaction
- Two-piece design i.e. visual inspection of interlocking leads to improved installation security
- OMNI FIT™ concept i.e. streamlined order management and reduced stock level
- Watertight sealing in mated and unmated condition, i.e. reduced efforts during installation and improved security during operation
- Unique NiTin plating i.e. extreme resistance against corrosion even under hardest climatic and environmental circumstances
- Multi-thread (Tristart) design i.e. simplified and accelerated tightening process
- RoHS (EU) and CRoHS (China) compliant i.e. can be used on a global basis

Technical features

GENERAL SPECIFICATIONS

Cable Size	1/2
Cable Type	Foam Dielectric
Model Series	LCF12-50 Series, ICA12-50 Series, RCF12-50 Series
Connector Interface	N
Connector Type	OMNI FIT™ PREMIUM Right Angle
Sealing Method	Polymer claw + 360° Compression

TESTING AND ENVIRONMENTAL

Waterproof Level	IP68
------------------	------

MECHANICAL SPECIFICATIONS

Plating Outer/Inner	Tri metal alloy/Silver
Length	69.05mm (2.718in)
Outer Diameter	29mm (1.142in)
Inner Contact Attachment	Basket
Outer Contact Attachment	360° clamping



NMR-LCF12-E01

N Male Connector for 1/2" Coaxial Cable, OMNI FIT™ Premium,  
Right Angle, polymer claw and compression sealing

ELECTRICAL SPECIFICATIONS

Nominal Impedance	50 ohms	
3rd Order IM Product @ 2x20 Watts	-156 ; typical -162	
Maximum Frequency	6 GHz	
Frequency Range	VSWR value	Return Loss value
0 < f ≤ 1.0 GHz	1.04	34
1.0 < f ≤ 2.2 GHz	1.06	31
2.0 < f ≤ 2.7 GHz	1.08	28
2.7 < f ≤ 3.8 GHz	1.11	26
3.8 < f ≤ 5.0 GHz	1.15	23
5.0 < f ≤ 6.0 GHz	1.22	20

ACCESSORIES

Trimming Tool	TRIM-SET-L12-D01 TRIM-LCF12-D01-A
---------------	--------------------------------------

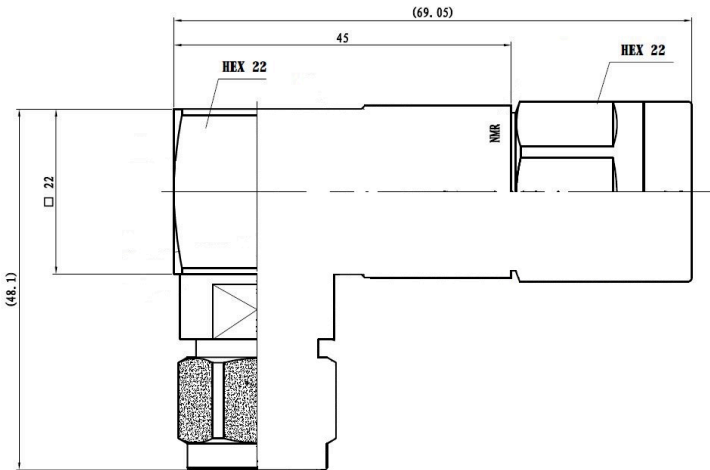

External Document Links

Notes