

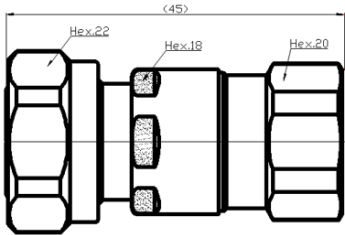

**43M-LCF12-ECO\_PRELIMINARY\_XiXia**  
4.3-10 Male Connector for 1/2" Coaxial Cable, ECO-Series

ECO Series connectors are designed for use with CELLFLEX® cables.

**Feature / Benefits**



- Cost effective two-piece design for safe and easy installation
- Superior electrical performance for consistent and repeatable VSWR i.e. ensure network system performance
- Waterproof to IP 67 i.e. no downtime risk, secures revenue
- RoHS (EU) and CRoHS (China) compliant i.e. can be used on a global basis

**Technical features**

**GENERAL SPECIFICATIONS**

Cable Size	1/2
Cable Type	Foam Dielectric
Model Series	LCF12-50 Series
Connector Interface	4.3-10
Connector Type	ECO Series
Sealing Method	O-ring

**TESTING AND ENVIRONMENTAL**

Waterproof Level	IP67
------------------	------

**MECHANICAL SPECIFICATIONS**

Plating Outer/Inner	Trimetal/Silver
Length	45mm (1.772in)
Outer Diameter	24mm (0.945in)
Inner Contact Attachment	Spring Finger
Outer Contact Attachment	Spring Finger

**ELECTRICAL SPECIFICATIONS**

Nominal Impedance	50 ohms	
3rd Order IM Product @ 2x20 Watts	-155 @1800MHz	
Maximum Frequency	6 GHz	
Frequency Range	VSWR value	Return Loss value
690 < f ≤ 960MHz	1.1	26.44
1700 < f ≤ 2700MHz	1.13	24.29
2700 < f ≤ 3000MHz	1.15	23.13
3000 < f ≤ 5000	1.2	20.83

External Document Links

Notes



**43M-LCF12-ECO\_PRELIMINARY\_XiXia**  
4.3-10 Male Connector for 1/2" Coaxial Cable, ECO-Series

**Related Documents**



**TML Value Proposition**  
Value Propositions