

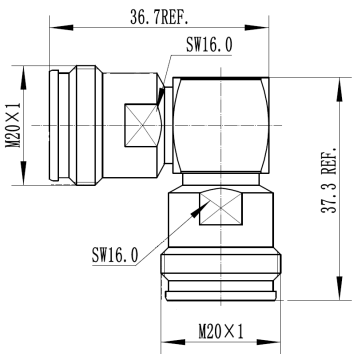

43F-R-43F

Coaxial Adapter 4.3-10 Female - 4.3-10 Female with right angle



Coaxial Adapter 4.3-10 Female - 4.3-10 Female with right angle

Technical features

STRUCTURE

Product Line	Coaxial Cable Components
Product Type	Coaxial Adapter

MECHANICAL SPECIFICATIONS

Connector A	4.3-10 Female
Center Contact Connector A	Copper Alloy, silver plated
Outer Contact Connector A	Copper Alloy, CuSnZn plated
Connector B	4.3-10 Female
Center Contact Connector B	Copper Alloy, silver plated
Outer Contact Connector B	Copper Alloy, CuSnZn plated
Dielectric	PTFE
Sealing class	IP68, connected

ELECTRICAL SPECIFICATIONS

Frequency Range - MHz	DC - 6000
VSWR	DC TO 2 GHz VSWR 1.05 (32.25) 2 TO 3 GHz VSWR 1.08 (28.3) 3 TO 6 GHz VSWR 1.12 (24.94)
Insertion Loss	0.05
3rd Order IM Product @ 2x20 Watts	-163 dBc

TEMPERATURE SPECIFICATIONS

Operation Temperature	-45 to 85 (-49 to 185)
-----------------------	------------------------

PACKAGING INFORMATION

Package Quantity	1
------------------	---

External Document Links

Notes